

PG32GR

适用范围/Typical applications:

遥控窗帘、微型数控设备、中央空调调节阀、机器人、柔巾机、舞台灯光、电脑座便器专用阀门电机、电动广告、可调角度望远镜、办公设备、家用电器、自动执行器。

Auto shutter, Micro CNC equipment, Central air-conditioning valve, Robots, Towel dispensers, Limelight, Automatic closet bowl special valve, Electric advertising, Angular telescope, Office equipment, Household appliances, Automatic actuator.



外形尺寸图/Appearance size

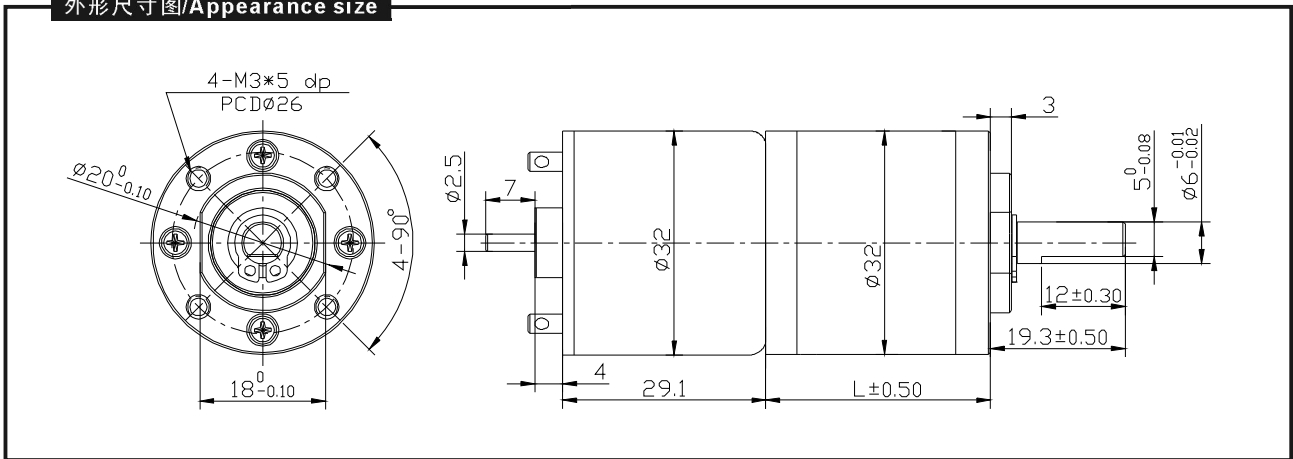

齿轮箱清单/Gearbox data:

级数 Number of stages	1 stages reduction	2 stages reduction	3 stages reduction	4stages reduction	5stages reduction
减速比Reduction ratio	3.3, 4.6	11.2, 15.5, 21.5	37.7, 52.1, 72, 100,	126, 174, 241, 334, 462,	423, 585, 810, 1120, 1549, 2142,
齿轮箱长度 Gearbox length "L" mm	20.7	26.4	32.2	38	43.8
最大额定力矩 Max. Running torque	5.0Kgf · cm	10.0Kgf · cm	25Kgf · cm	25Kgf · cm	25Kgf · cm
最大损坏扭力 Max. Gear breaking torque	15.0Kgf · cm	30.0Kgf · cm	75Kgf · cm	75Kgf · cm	75Kgf · cm
效率Gearing efficiency	90%	81%	73%	65%	59%

马达清单/Motor data:

马达型号 Motor name	额定电压 Rated Volt. V	空载No load		负载扭矩Load torque				堵转扭矩Stall torque	
		Current	Speed	Current	Speed	Torque	Output power	Torque	Current
		mA	r/min	mA	r/min	gf · cm	W	gf · cm	mA
GR124500	12	≤90	4500	≤220	3589	67.6	2.5	358	1500
GR127000	12	≤140	7000	≤700	5647	79.7	4.6	472	3030
GR244500	24	≤50	4500	≤160	3539	60	2.1	281	596
GR246700	24	≤70	6700	≤280	4500	78.4	4.23	381	1140

1、减速后的输出力矩=马达力矩X减速比X齿轮效率。输出转速=马达转速/减速比。

1、 After connecting motor and gearbox which is named gearmotor the output torque: motor torque X reduction ratio X gearing efficiency; output speed: motor speed / reduction ratio.

NOTE:

- 1、 马达命名：如PG32GR244500-72K。马达参数如马达清单上的GR244500, 齿轮减速比参数如齿轮箱清单上的72, 马达的输出转速和输出力矩请参照上表的马达清单。
 - 2、 马达可安装的译码器参数请参照第46页。
 - 3、 标准输出轴为Φ6.0mm, 其它尺寸可根据客户要求制作。
 - 4、 以上参数仅作参考, 具体以实物为准。
- 1、 Gearmotor named methods: e.g. PG32GR244500-72K Motor please refer to the motor data GR244500. Gearbox please refer to gearbox data reduction ratio 72. Related to gearmotor output speed and torque please refer to motor data.
- 2、 Motor can be installed with magnetic encoder, encoder parameters please refer to Page 46.
- 3、 Standard output shaft after reducing: Φ6.0mm. other sizes of the output shaft can make as client request.
- 4、 Chart only for reference, products shall prevail the entity.